

## MODEL(S)

miniFactory-BENCHMARK

## PROFILE

Sabic ULTEM AM1010F v2.0

## PRINT DURATION

1h 9min 38s

## FILAMENT CONSUMPTION (E0)

4.47 m / 13.85 g

## FILAMENT CONSUMPTION (E1)

0.00 m / 0.00 g

## PRINTED BY

OP

## PRINTED ON

2020-09-10

## FILAMENT SPOOL ID

E0: 288870130 / E1: -

Extruder 0 Temperature / °C ✓

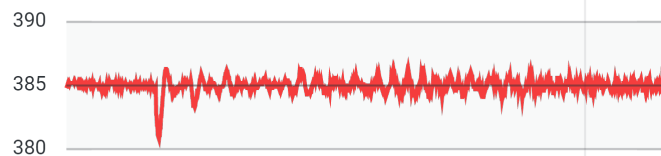

Chamber Temperature / °C ✓

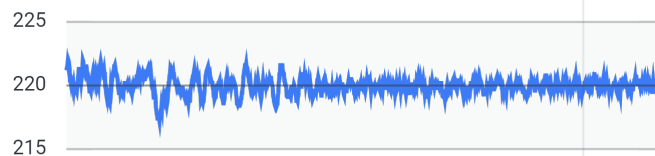

Filament Chamber Temp. / °C ✓

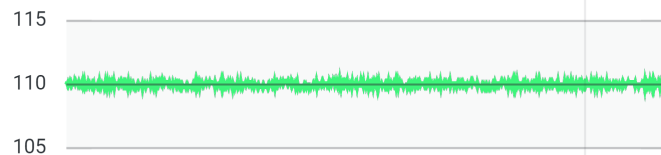

Filament Chamber Humidity / %RH ✓

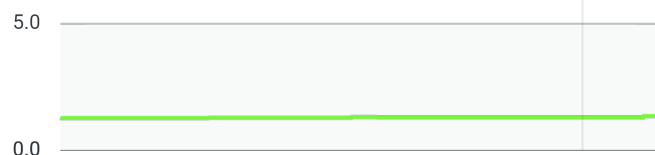

Hot Blower Speed / %

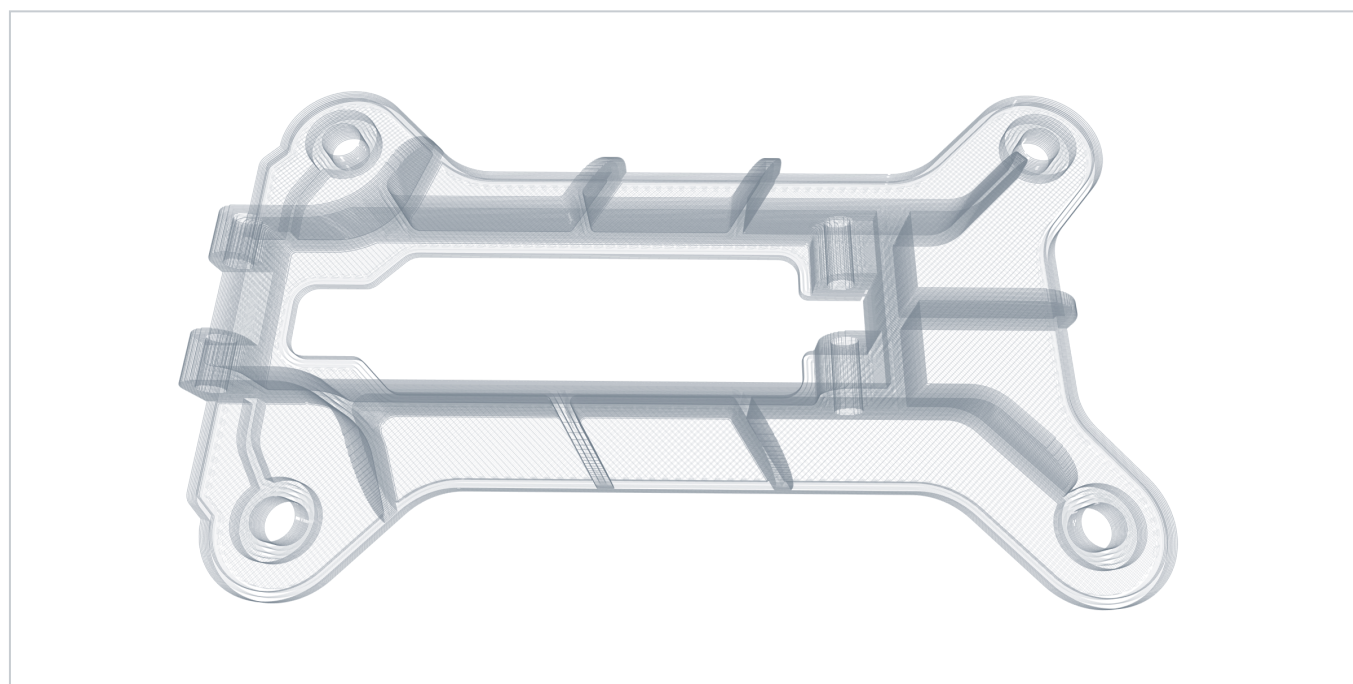

SENSOR	MEAN	SET POINT	RMSD*	INFILL	100% Rectilinear
Extruder 0 Temperature / °C	385.0	385.0	0.5	LAYER HEIGHT	0.25 mm
Chamber Temperature / °C	220.0	220.0	0.6	DEFAULT SPEED	35 mm/s
Bed Temperature / °C	220.6	220.0	0.7	PERIMETERS	3
Filament Chamber Temp. / °C	110.0	110.0	0.1	TOP LAYERS	4
Filament Chamber Humidity / %RH	1.3	0.0	1.3	BOTTOM LAYERS	2
Skirt and support structures excluded		* root-mean-square deviation			

#### QUALITY CHECKLIST

- ☒ miniFactory printing process was followed
- ☒ miniFactory profile designed for the material was used
- ☒ Printing platform was cleaned before printing
- ☒ Material was pre-dried
- ☒ Correct nozzle was used

#### LAYER NOTIFICATION

2 Bed heating was disabled according to the printing profile.

---

OP 16.9.2020